

File Name: P:\Projects\2013\13-0107-004\DocControl\ToBeIssued\DWG\13-0107-004_FIG01-Rev0.dwg - Tab: FIGURE 1 Plotted By: Gluewen 13/06/04 [Tue 9:49am] 11x17" PLOT SCALE: 1:2

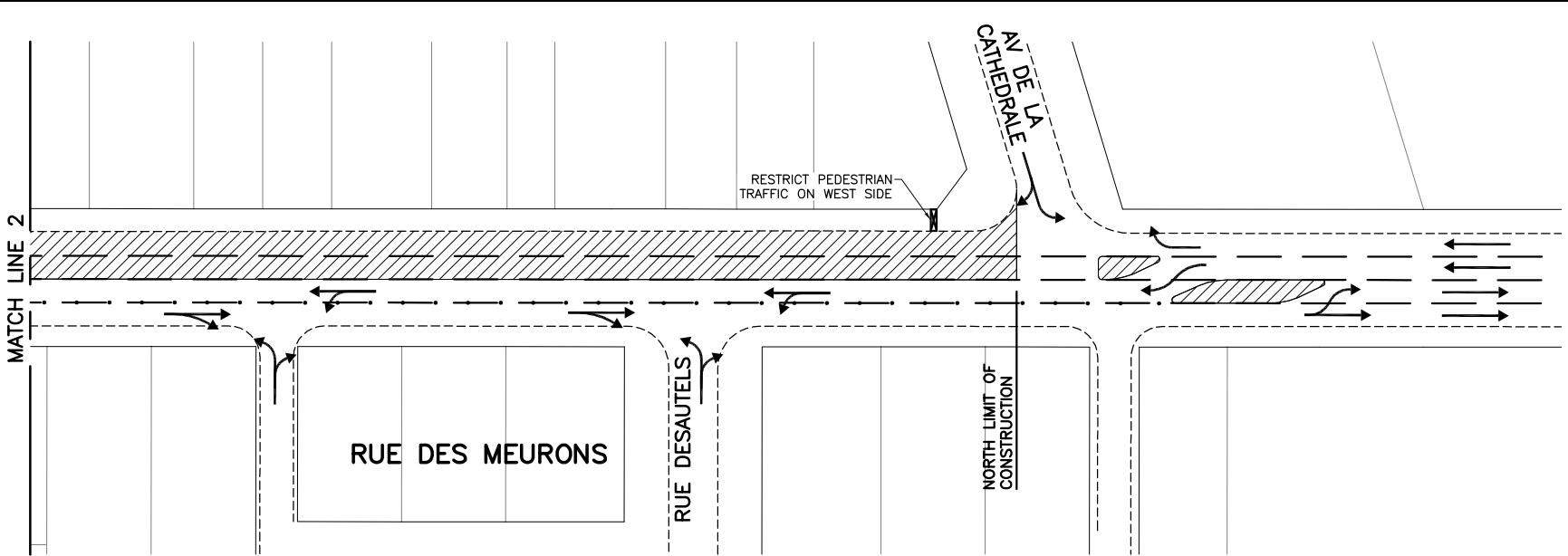
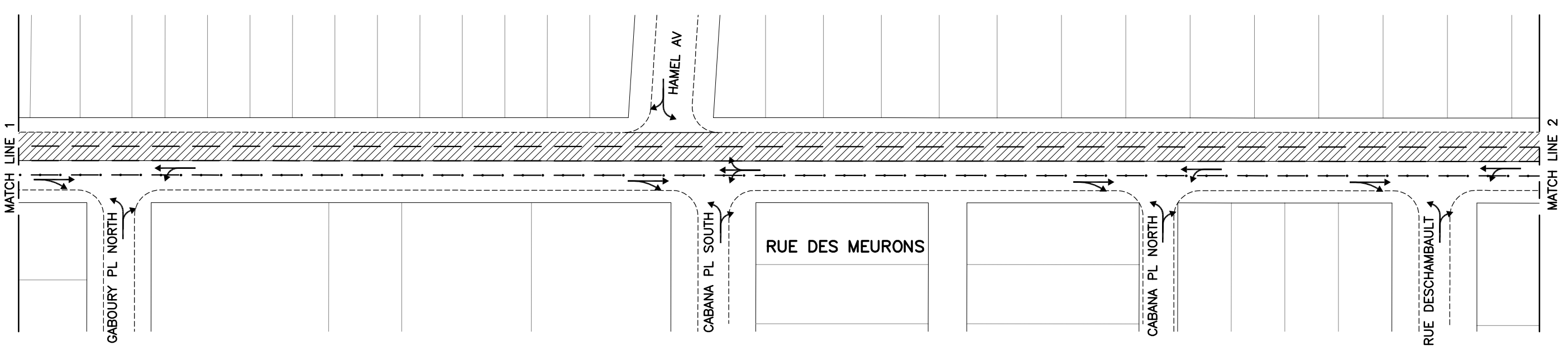
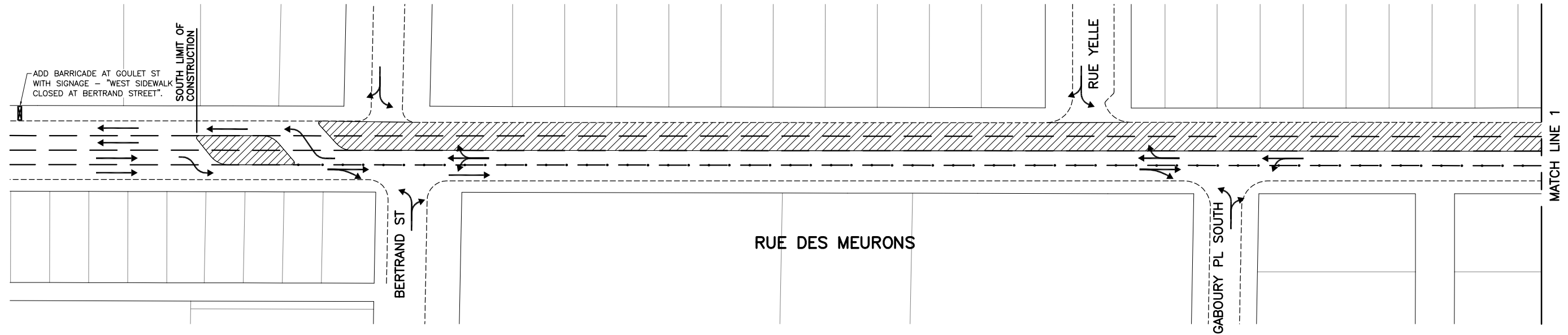

LEGEND

- EDGE OF ROAD
- LANE LINE
- ▨ LANE CLOSURE
- TRAFFIC MOVEMENT
- ⊠ BARRIERS
- • • PYLONS

- GENERAL NOTES:**
1. CONTRACTOR TO CONTACT LORI GARET, P.ENG. AT THE CITY OF WINNIPEG (204-986-5900) AND LANE CLOSURES (204-986-5178) TO COORDINATE TRAFFIC MANAGEMENT PLAN.
 2. CONTRACTOR WILL BE RESPONSIBLE FOR SETTING UP LANE CLOSURES.
 3. LANE CLOSURES SHALL BE IN ACCORDANCE WITH THE CITY OF WINNIPEG MANUAL OF TEMPORARY TRAFFIC CONTROL.
 4. ACCESS TO INTERSECTING STREETS AND PRIVATE APPROACHES SHALL BE MAINTAINED DURING CONSTRUCTION.

0	13/06/04	ISSUED FOR TENDER	BJM
NO.	YY/MM/DD	DESCRIPTION	BY
REVISIONS / ISSUE			
KGS GROUP CONSULTING ENGINEERS		 THE CITY OF WINNIPEG WATER AND WASTE DEPARTMENT	
2013 LOCAL STREET REHABILITATION PROGRAM			
RUE DES MEURONS TRAFFIC MANAGEMENT PLAN PHASE 1			
MAY 2013		FIGURE 1	REV. 0